

ATTACCHI SPECIFICI PER - SPECIFIC FITTING KIT FOR  
 KIT DE MONTAGE SPECIFIQUE POUR - SPECIFISCHER MONTAGEKIT FÜR  
 ANCLAJE ESPECÍFICO PARA

# APRILIA SCARABEO 250 (06-07)

ISTRUZIONI DI MONTAGGIO - MOUNTING INSTRUCTIONS  
 INSTRUCTIONS DE MONTAGE - BAUANLEITUNG - INSTRUCCIONES DE MONTAJE

①



**SUPPORTO**  
 SUPPORT  
 SUPPORT  
 HALTERUNG  
 SOPORTE

**Q.TY n.2(Dx-Sx)**

②



**VITE TCEI M8x35mm**  
 SCREW M8x35mm  
 VIS M8x35mm  
 SCHRAUBE M8x35mm  
 TORNILLO M8x35mm

**Q.TY n.2**

③



**VITE TBEI M6x25mm**  
 SCREW M6x25mm  
 VIS M6x25mm  
 SCHRAUBE M6x25mm  
 TORNILLO M6x25mm

**Q.TY n.4**

③



**BOCCOLA DI RITENZIONE Z871N**  
 PLASTIC BUSH  
 DOUILLE PLASTIQUE  
 PLASTIK BÜCHSE  
 CASQUILLO

**Q.TY n.4**

④



**GOMMINO Z268**  
 FAIRLEADER  
 CHAUMARD  
 GUMMI  
 GOMA

**Q.TY n.4**

⑥



**DADO A.B. M6**  
 FLANGIATO  
 BOLT M6  
 ECROU M6  
 MÜTTERCA M6  
 TUERCA M6

**Q.TY n.4**

⑦

**AIRSTAR 130A**  
**Q.TY n.-**

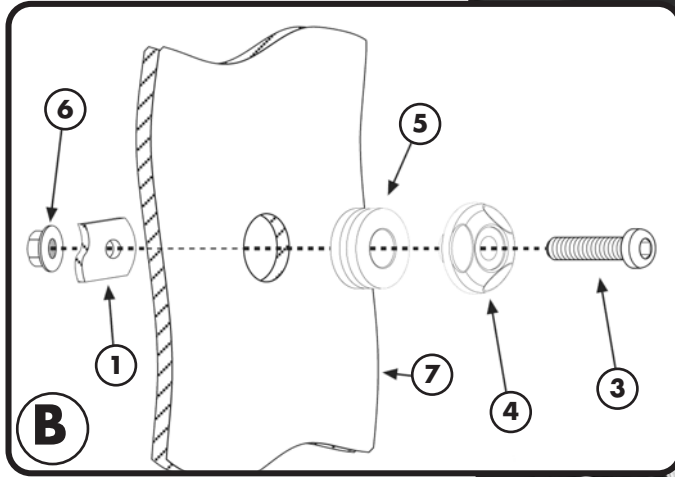
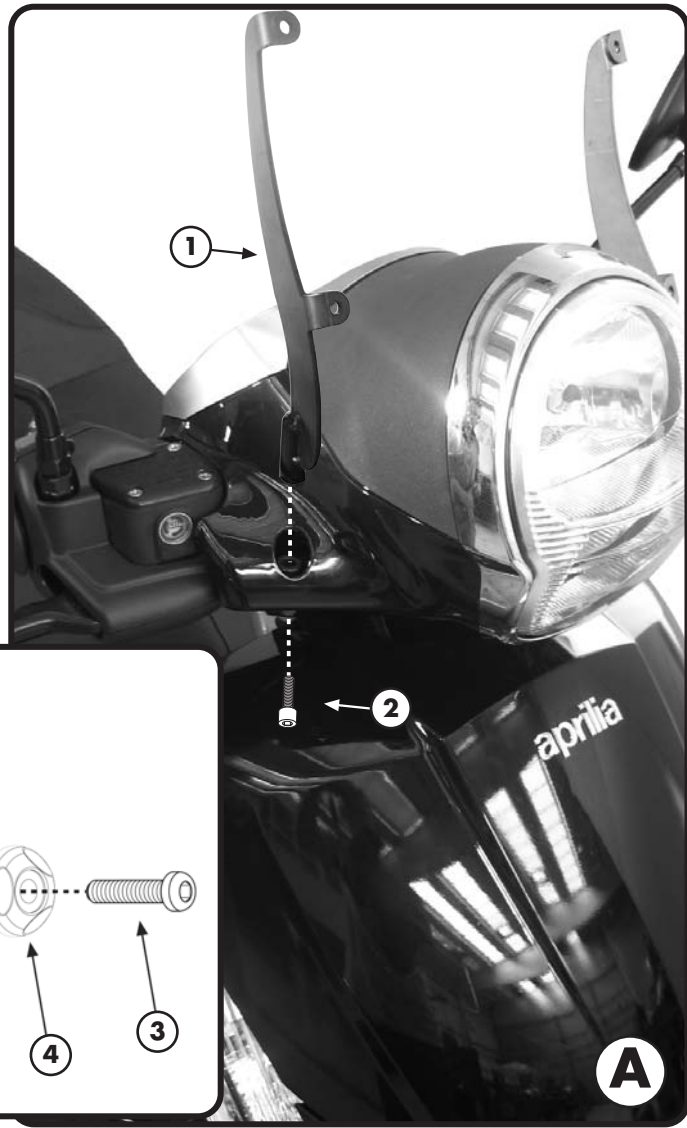

A148A - A148A

ATTACCHI SPECIFICI PER - SPECIFIC FITTING KIT FOR  
KIT DE MONTAGE SPECIFIQUE POUR - SPEZIFISCHER MONTAGEKIT FÜR  
ANCIJALE ESPECIFICO PARA

**APRILIA SCARABEO 250 (06-07)**

ISTRUZIONI DI MONTAGGIO - MOUNTING INSTRUCTIONS  
INSTRUCTIONS DE MONTAGE - BAUANLEITUNG - INSTRUCCIONES DE MONTAJE

## I ISTRUZIONI DI MONTAGGIO

- RIMOVERE I DUE TAPPINI ORIGINALI SUL MANUBRIO.  
- MONTARE IL SUPPORTO "1" COME INDICATO IN FIGURA "A".  
- SEGUIRE IL MONTAGGIO DEL PARABREZZA 130A (NON INCLUSO) INDICATO IN FIGURA "B".  
- SERRARE TUTTE LE VITI.

## GB MOUNTING INSTRUCTIONS

1. REMOVE THE TWO ORIGINAL CAPS ON THE HANDLEBARS.
2. MOUNT THE SUPPORT "1" AS SHOWN IN FIGURE "A".
3. FOLLOW THE INSTALLATION OF THE WINDSCREEN 130A (NOT INCLUDED) INDICATED IN FIGURE "B".
4. TIGHTEN ALL THE SCREWS.

## F INSTRUCTIONS DE MONTAGE

1. ENLEVER LES DEUX CACHES D'ORIGINE SUR LE GUIDON.
2. MONTER LE SUPPORT "1" COMME INDIQUE EN PHOTO "A".
3. SUIVRE L'ASSEMBLAGE DU PARE-BRISE 130A (NON INCLUS)
4. SERRER TOUTES LES VIS.

## D BAUANLEITUNG

1. ENTFERNEN SIE DIE 2 ORIGINALSTÖPSEL AUF DEM LENKER.
2. MONTIEREN SIE DIE HALTERUNG „1“ WIE IM BILD A HINGEWIESEN.
3. MONTIEREN SIE DIE SCHEIBE 130A (NICHT ENTHALTEN) WIE IM BILD „B“ GEZEIGT.
4. ZIEHEN SIE ALLE SCHRAUBEN FEST.

## ES

## INSTRUCCIONES DE MONTAJE

DESMONTAR LOS DOS TAPONES ORIGINALES SITUADOS SOBRE EL MANILLAR.  
MONTAR EL SOPORTE "1" COMO SE INDICA EN LA FIGURA "A".  
SEGUIR CON EL MONTAJE DEL PARABRISAS 130A, no INCLUIDO, INDICADO EN LA FIGURA "B".  
APRETAR TODOS LOS TORNILLOS