

A307A - A307A

ATTACCHI SPECIFICI PER - SPECIFIC FITTING KIT FOR
KIT DE MONTAGE SPECIFIQUE POUR - SPEZIFISCHER MONTAGEKIT F R
ANCLAJE ESPECCEFICO PARA

HONDA SH 300i 2007

ISTRUZIONI DI MONTAGGIO - MOUNTING INSTRUCTIONS
INSTRUCTIONS DE MONTAGE - BAUANLEITUNG - INSTRUCCIONES DE MONTAJE

1



Q.TY n.-

2



SUPPORTO
SUPPORT
SUPPORT
HALTERUNG
SOPORTE

Q.TY n.2(Dx-5x)

3



VITE TE M8x55mm
SCREW M8x55mm
VIS M8x55mm
SCHRAUBE M8x55mm
TORNILLO M8x55mm

Q.TY n.4

4



VITE TBEI M6x25mm
Nero
SCREW M6x25mm
VIS M6x25mm
SCHRAUBE M6x25mm
TORNILLO M6x25mm

Q.TY n.4

5



DADO A.B. M6
Flangiato Nero
BOIT M6
ECROU M6
MUTTER M6
TUERCA M6

Q.TY n.4

6

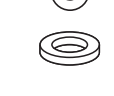

RONDELLA f8mm
WASHER
RONDELLE
SCHEIBE
ARANDELA

Q.TY n.4

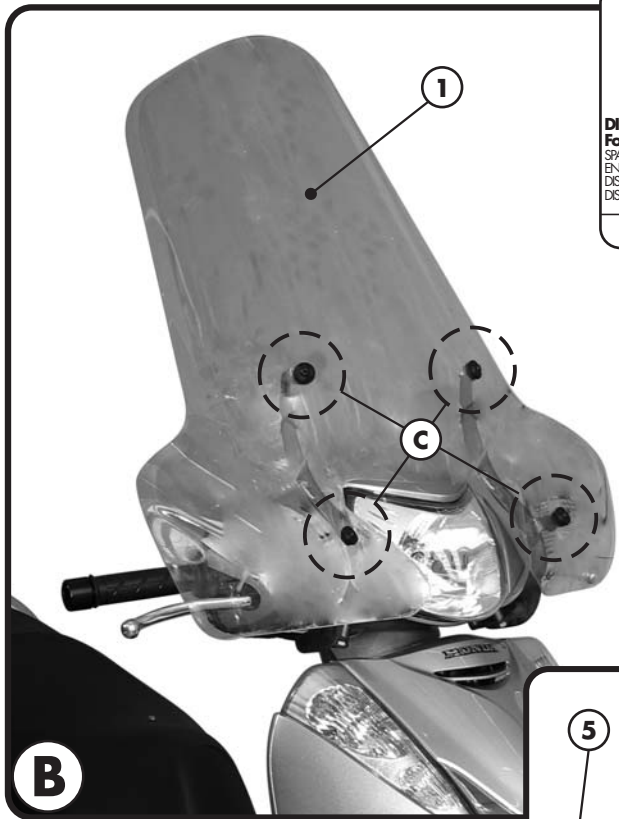
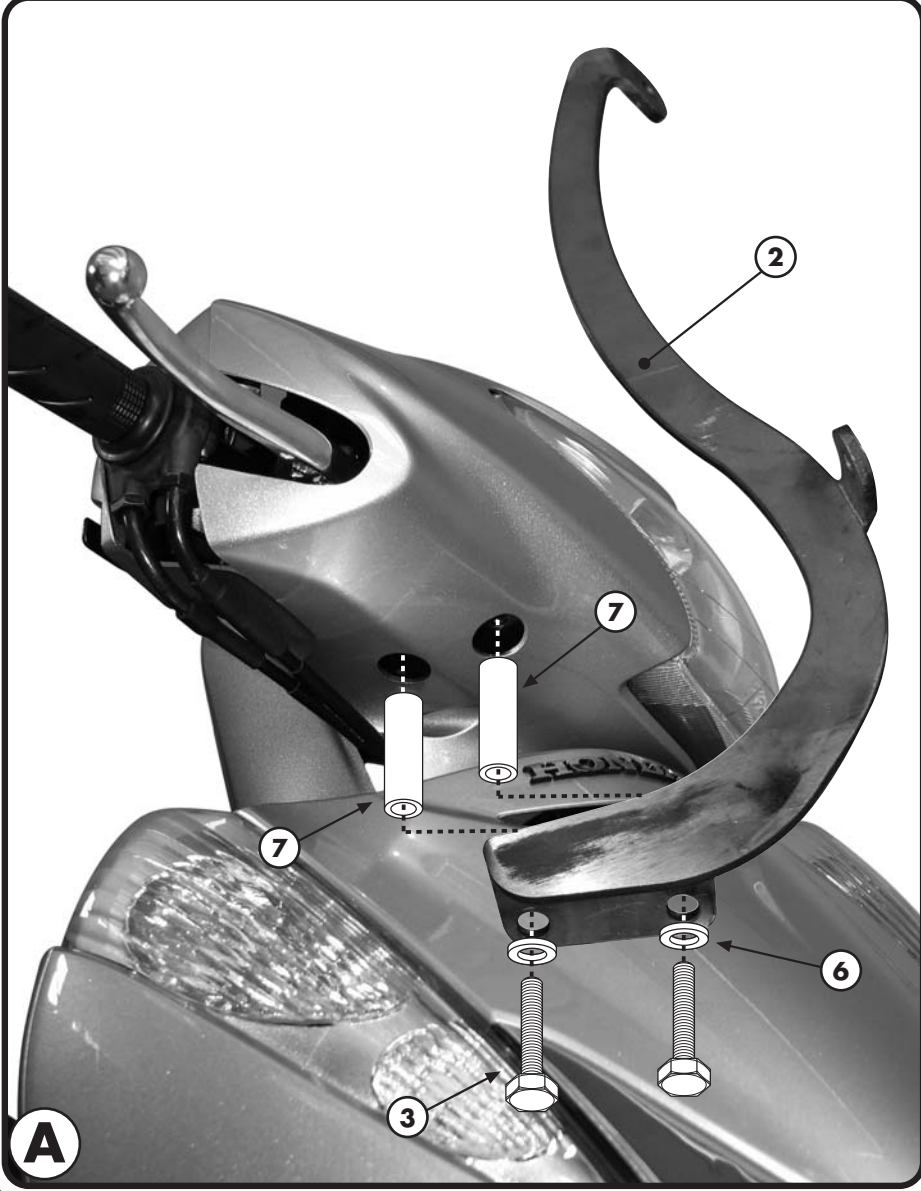

7

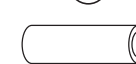

DISTANZIALE f14x37mm
Foro f10mm, V612
SPACER
ENTRETOISE
DISTANZSTUECK
DISTANCIADOR

Q.TY n.4

8



BOCCOLA DI RITENZIONE
Z871N
PLASTIC BUSH
DOUILLE PLASTIQUE
PLASTIK BUCHSE
CASQUILLO

Q.TY n.4

9



GOMMINO Z268
FAIRLEADER
CHAUMARD
GUMMI
GOMA

Q.TY n.4

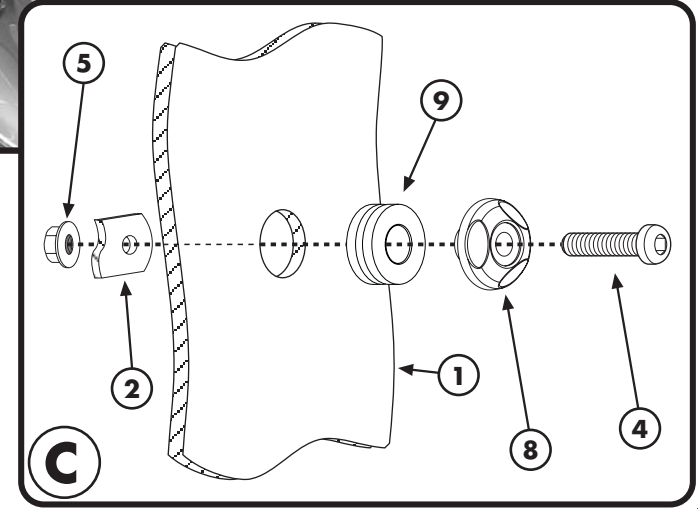

**ATTACCHI SPECIFICI PER - SPECIFIC FITTING KIT FOR
KIT DE MONTAGE SPECIFIQUE POUR - SPEZIFISCHER MONTAGEKIT F R
ANCLAJE ESPECCEFICO PARA**

HONDA SH 300i 2007

ISTRUZIONI DI MONTAGGIO - MOUNTING INSTRUCTIONS
INSTRUCTIONS DE MONTAGE - BAUANLEITUNG - INSTRUCCIONES DE MONTAJE

I ISTRUZIONI DI MONTAGGIO

1. MONTARE I SUPPORTI N°2 COME INDICATO IN FOTOGRAFIA A;
2. MONTARE IL PARABREZZA (NON INCLUSO) COME INDICATO IN FOTOGRAFIA B FACENDO RIFERIMENTO ALL'IMMAGINE C;
3. ULTIMARE IL MONTAGGIO CONTROLLANDO CHE LE VITI SIANO SERRATE BENE.

GB MOUNTING INSTRUCTIONS

1. MOUNT THE SUPPORTS N° 2 AS SHOWN IN PICTURE A;
2. MOUNT THE WINDSCREEN (NOT INCLUDED) AS SHOWN IN PICTURE B AND ALSO MAKING REFERENCE TO PICTURE C;
3. LASTLY CHECK THAT ALL SCREWS HAVE BEEN TIGHTENED.

F INSTRUCTIONS DE MONTAGE

1. DEMONTER LES SUPPORTS N.2 COMME INDIQUE EN PHOTO A;
2. MONTER LE PARE-BRISE (PAS INCLUS) COMME INDIQUE EN PHOTO B EN SE REFERANT A L'IMMAGE C ;
3. TERMINER LE MONTEGE EN CONTROLANT LE BON SERRAGE DE TOUTES LES VIS.

D BAUANLEITUNG

1. MONTIEREN SIE DIE HALTERUNGEN NR. 2 WIE IM BILD A BESCHRIEBEN;
2. MONTIEREN SIE DAS WINSCHILD (NICHT VORHANDEN) WIE IM BILD A BESCHRIEBEN UND NEHMEN SIE BEZUG AUF BILD C.
3. ZULETZT ÜBERPRÜFEN SIE, DASS ALLE SCHRAUBEN FESTGEZOGEN WURDEN.

ES

INSTRUCCIONES DE MONTAJE

1. MONTAR LOS SUPORTES COMO INDICADO EN LA FOTOGRAFIA "A";
2. MONTAR EL PARABRISAS (NO INCLUIDO) COMO EN LA FOTOGRAFIA "B", HACE REFERENCIA A LA IMAGEN "C";
3. FINALIZAR EL MONTAJE ASEGURANDESE DE QUE TODOS LOS TORNILLOS ESTEN BIEN APRETADOS.